

OPERATING INSTRUCTIONS

NOTE: This Remote Control unit is for F617L,F745,F905,F905L,F899L,F868L,F1001 fans only.

NOTE: The Aire Control® System for these DC motor fans is equipped with a learning frequency function which has 32 code combinations to prevent potential interference from other remote units. The frequency on your Receiver and Transmitter units have been preset at the factory. (Fig. 1) No frequency change is necessary, should you desire to install another Minka Aire DC motor fan within the same home or area with a separate frequency code please see the " frequency setting" section below to learn how to change the frequency.

FREQUENCY SETTING

- Turn the power off to your ceiling fan.
- Please use a small size tool to change the frequency settings on the control system.
- Re-run power to the unit.

Note: After the AC power is on, do not press any other button on the transmitter before pressing the "Stop" button, doing so will cause the procedure to fail.

- Within 60 seconds of turning the fan's AC power ON. Press the transmitter's "Stop" button and hold the "Stop" button for 10 seconds.
- Once the receiver has detected the set frequency, the down light of your fan will blink twice and the fan will begin to rotate for a short period and then shut off.
- The receiver has now learn the frequency which has been selected on the transmitter. After completing the steps above, you should be able to operate the ceiling fan and light. If the fan is not responding to the transmitter. Please turn the power off to the receiver, and repeat the process.

Note: The learning frequency function will continue to retain the last set frequency even when the AC power is shut off.

"DIMMER" and "ON/OFF" dip switch:

The "DIMMER" selection is the light dimmable selection and is to be used with all bulbs except for CFL bulbs.

The "ON/OFF" selection is For CFL bulbs.

REMOTE CONTROL OPERATING INSTRUCTIONS

Restore power to ceiling fan and test for proper operation.

Install a A23 12 volt battery (included). To prevent damage to the transmitter remove the battery if it is not used for long periods of time.





A. 1, 2, 3, 4, 5 and 6 button:

These six buttons are used to set the fan speed as follows:

- 1 = Low speed
- 2 = Medium Low speed
- 3 = Medium speed
- 4 = Medium High speed
- 5 = High speed
- 6 = Extra High speed

B.  Reverse button: This button is used to change the direction of the rotation of the blades; forward for warm weather or reverse for cool weather.

C.  Button: This button turns the power Off to the Fan.

D.  Button: These buttons turn the light ON or OFF. The following instructions apply to ceiling fans that feature a DOWN light ( button) only or ceiling fans that feature an UP light ( button) and a DOWN light ( button) that are controlled independent of each other;

Press and release the button for the desired light to turn the light ON or OFF. Press and hold the button to set the desired light brightness. The light will cycle between bright and dim settings as long as the button is pressed. The light key has an automatic auto-resume feature that allows the light to remain at the same brightness as the last time it was turned off.

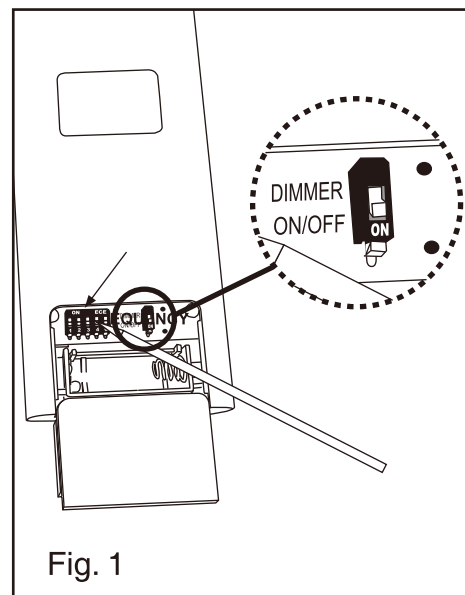

Fig. 1



Fig. 2