

INSTALLATION & OPERATING INSTRUCTIONS READ AND SAVE THESE INSTRUCTIONS

for model RC210
U.S. Patents: D533,514; D551,008
Additional U.S. Patent(s) Pending

WARNING! SHUT POWER OFF AT FUSE OR CIRCUIT BREAKER

NOTE: The RC210 Universal Hand Held Remote Control System is equipped with 16 code combinations to prevent possible interference from or to other remote units. Remove the back cover of the battery compartment. Check the frequency switches against the ones from the wall control or remote control unit included with your fan and make sure the switches on both units are set to the same positions. The frequency settings should only be changed in case of interference or if a second or more remote controlled ceiling fans are installed in the same structure. Any code combination will operate the ceiling fan and light as long as the Receiver and Transmitter units are set to the same frequency codes (Fig. 1)

Install the A23, 12v battery included. Remove the battery if not used for long periods of time to prevent damage to the hand held remote.

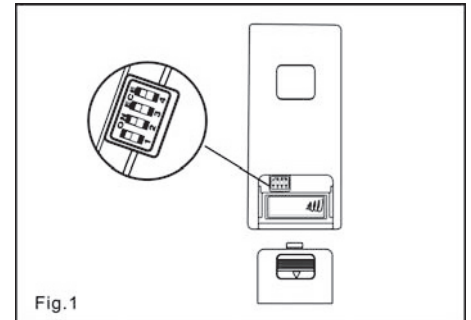

Fig.1

OPERATING THE HAND HELD REMOTE CONTROL

1. Light Button:

Press and release the button to turn the light ON or OFF. Press and hold the button to set the desired light brightness. The light will cycle between bright and dim settings as long as the button is pressed. The light key has an automatic auto-resume feature that allows the light to remain at the same brightness as the last time it was turned off. The Up-light button applies to ceiling fans that feature an Up-light only.

2. Speed Buttons

Press and release the button for the desired speed.

3. Reverse Button

Use this button to change the blade rotation.

4. Stop Button

This button stops the fan.

Use the screw provided to install the wall holster on the wall or another convenient location of your choice.

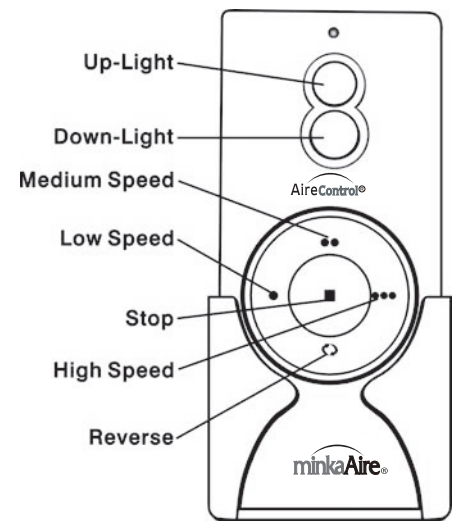

The installation of your new RC210 Universal Hand Held Remote System is complete.

This product is protected by United States Federal and/or State Law, including Patent, Trademark and/or Copyright laws

Manual design and all elements of manual design are protected by U.S. Federal and/or State Law, including Patent, Trademark and/or Copyright laws.