

INSTALLATION INSTRUCTIONS

For Model 77800-66-L

READ AND SAVE THESE INSTRUCTIONS

WARNING! SHUT POWER OFF AT FUSE OR CIRCUIT BREAKER.

AVERTISSEMENT! COUPER LE COURANT AU NIVEAU DES FUSIBLES OU DU DISJONCTEUR.

HANGING THE FIXTURE (Fig. 1)

1. Shut off power at the fuse box or circuit breaker box and remove the old fixture including the mounting hardware.
2. Carefully unpack your new fixture and lay out all the parts in a clear area. Take care not to misplace any small parts necessary for installation.
3. Disassemble the pre-installed frame (G) from backplate (D) by loosening mounting screws (E) and washers (F). Remove the package inside the frame (G) before installing.
4. Unscrew the mounting screws (E) & washers (F) to separate the mounting plate (B) from backplate (D).
5. Attach the mounting plate (B) to the outlet box (A) (not supplied) with outlet box screws (C). (Size: #8-32*0.78"L). The side of mounting plate (B) marked "GND" must face out.

CONNECTING THE WIRES (Fig. 2).

6. Connect the electrical wires as shown in Fig. 2. Make sure that all wire connectors are secured. If your outlet box has a ground wire (green or bare copper), connect the fixture's ground wire to it. Otherwise, connect the fixture's ground wire directly to the mounting plate (B) using the green screw provided.

COMPLETING THE INSTALLATION (Fig. 1)

7. Align the backplate (D) to mounting plate (B) and secure with mounting screws (E) and washers (F).
8. Secure the frame (G) back to backplate (D) by mounting screws (E) and washers (F).
9. Bulb information: Integrated LED module 1x LED 8W included for 77800-66-L.
10. To prevent moisture from entering the outlet box and causing a short, use clear caulking (i.e. Indoor/Outdoor Silicone Sealant) to outline the outside of fixture back plate where it meets the wall leaving a space at bottom to allow moisture a means to escape. (Fig. 3)

DO NOT EXCEED THE MAXIMUM WATTAGE RATING! (NE PAS DEPASSER LA PUISSANCE NOMINALE MAXIMALE!)

Your installation is now complete. Return power to the junction box and test the fixture.

Fig.1

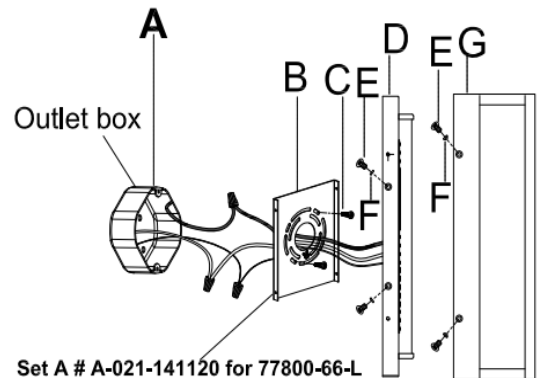

Set A # A-021-141120 for 77800-66-L

- Mounting plate
- Ground screw
- Outlet box screws(2)

Fig. 2

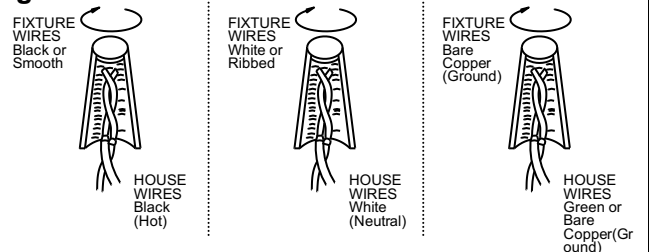
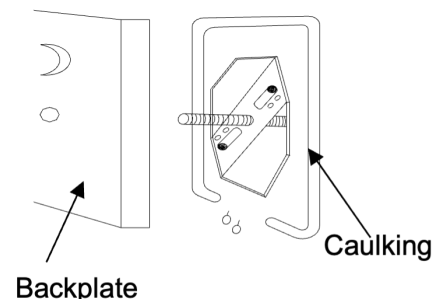

Fig. 3



INSTALLATION INSTRUCTIONS

For Model 77800-66-L

READ AND SAVE THESE INSTRUCTIONS

WARNING! SHUT POWER OFF AT FUSE OR CIRCUIT BREAKER.

AVERTISSEMENT! COUPER LE COURANT AU NIVEAU DES FUSIBLES OU DU DISJONCTEUR.

Replacing LED module (Fig.4)

The LED module can be replaced by a qualified electrician Without cutting of wire and without damage to any decorative element to which the fixture is attached. See installation steps for more details (Fig 4.)

- Shut off the power.
- To remove fixture from the wall, loosen mounting screws (E) and washers (F). Remove the wire connectors Place the fixture on a clear flat surface.
- Loosen screws (P) to remove small shade (O) and long shade (Q) from back plate (D).
- Loosen screws (L) to remove LED module (K) from back plate (D).
- Press the button on printed "L" quick connector on LED module (K) with screwdriver (Not included) to disconnect black wire. Repeat by pressing the button on printed "N" quick connector on LED module (K) to disconnect white wire.
- Apply heat sink silicon on the back of new LED module.
- Reverse steps b-e for installing the new LED module.
- Silicon seal should be applied around the screw and in the cable entry.

Your installation is now complete. Return power to junction box and test the fixture.

Fig.1

