

INSTALLATION INSTRUCTIONS

Model # 77604-899

READ AND SAVE THESE INSTRUCTIONS

WARNING! SHUT POWER OFF AT FUSE OR CIRCUIT BREAKER.

AVERTISSEMENT! COUPER LE COURANT AU NIVEAU DES FUSIBLES OU DU DISJONCTEUR.

PREPARING FOR INSTALLATION (Fig. 1)

1. Shut off power at the fuse box or circuit breaker box and remove the old fixture including the mounting hardware.
2. Carefully unpack your new fixture and lay out all the parts in a clear area. Take care not to misplace any small parts necessary for installation.
3. Determine the desired hanging height and thread rods (I, K), to the all thread (L) of the fixture body (M). Carefully feed wires through each rod and gasket (J) as you assemble,
4. Push fixture wires through swivel (G), screw collar (H), canopy (F) and threaded pipe (D). Thread swivel (G) to rod (I).
5. Slip screw collar (H) and canopy (F) over swivel (G) and allow them to rest on rods (I, K). Thread swivel (G) to threaded pipe (D) of cross bar (C).
6. Attach cross bar (C) (part #:A-016) to outlet box (A) (not included) with outlet box screws (E) (size:8-32*1/2L). Note:the side of cross bar (C) marked "GND" must face out. The length of threaded pipe (D) into cross bar (C) maybe adjusted if necessary. Then tighten with hex nut and lock washer provided.

CONNECTION THE WIRES (Fig. 2)

7. Connect the electrical wires as shown in Fig.2. Making sure that all wire connectors (B) are secured. If your outlet box (A) has a ground wire (green or bare copper), connect the fixture's ground wire to it. Otherwise, connect the fixture's ground wire directly to the cross bar (C) using the green screw provided.

FINISHING THE INSTALLATION (Fig.1)

8. Position canopy (F) up against ceiling and thread screw collar (H) to secure the canopy (F) to ceiling.
9. Unscrew the screws (Q), separate the cover (P) from fixture body (M), and install glass shade (O) into the holder of fixture body (M) and secure the cover (P) with screws (Q) again.
10. Install (1) one medium base bulb (N) up to 60 watts or CFL or LED equivalent (not included) in accordance with the fixtures specification. **(DO NOT EXCEED THE MAXIMUM WATTAGE RATING!) (NE PAS DEPASSER LA PUISSANCE NOMINALE MAXIMALE!)**

Your installation is now complete. Return power to the outlet box and test the fixture.

Fig. 1

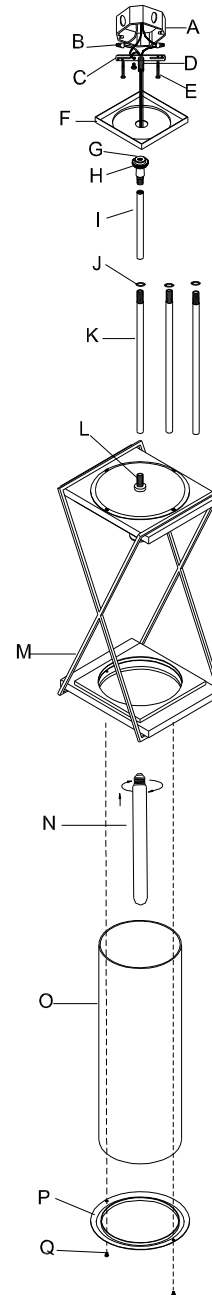

Part# A-021-127127
 Cross bar
 Mounting Screw (2)
 Grounding Screw(1)
 All thread and nut (1)

Rod#
 W30-H-732*1 (I-6")
 W30-I-732*3 (K-12")

IMPORTANT: FIXTURE SHOULD BE INSTALLED BY A QUALIFIED ELECTRICIAN TO ENSURE PROPER WIRING AND INSTALLATION.



Fig. 2

